



Contents

Installation Instructions 2

Operation Instructions 4

GSD))) i770

Grade 2 Wi-Fi Plug on IP
Board Communicator

Control Panel Opening

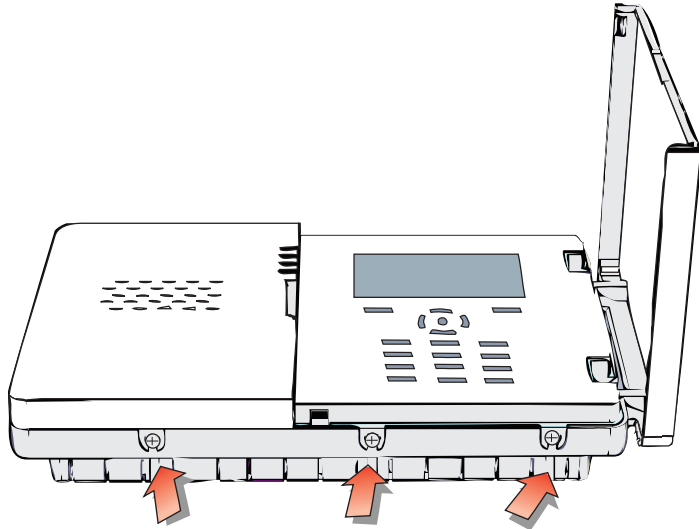

1: loosen retaining screws to release covers

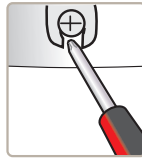

2: lift Cover 1 upwards to remove before removing Cover 2

3: lift cover 2 upwards to remove

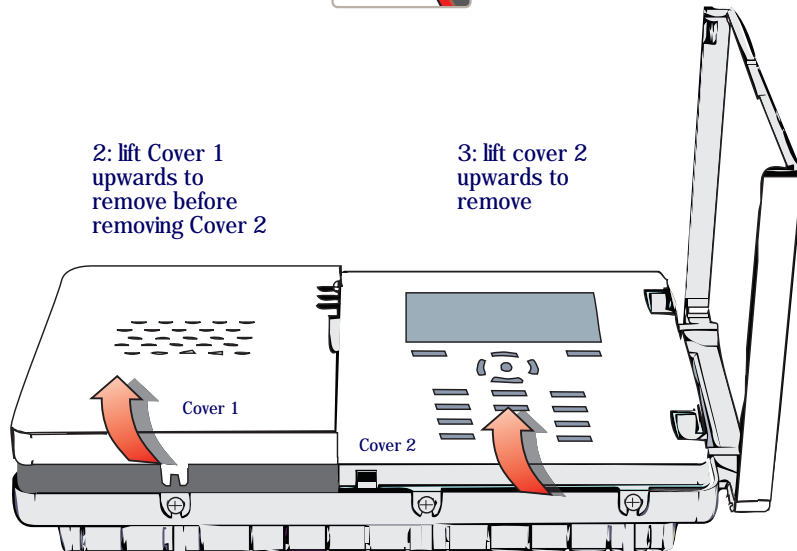

6. Customer registration

The following process is required to activate the customer account for the new site.

1. The customer should download the GSD-i70 App.
2. The customer registers a new account by filling in the form in the App and logs in.
3. The customer enters the Passcode from the panel created in step 5. This associates the customer with the site.
4. A notification is sent to the installer email account to activate the customer account.
5. The installer activates the customer account by clicking on the link within the email.
6. The customer can now log in to the new site.

5. Register the GSD-i70 Panel

In the installer menu on the GSD-i70 panel, navigate to:

1) Communications/WiFi Setting.

- Enter the Wifi Name (SSID)
- Enter Wifi Password

Wait while Wifi IP Board connects to wireless router (It may take up to two minutes to connect)

Check status in Remote Monitor/Connection Status

2) Communication/Remote Monitor.

- Enter the installer Account Number provided by GSD on first registration.
- Enter the Site ID created in step 4 when the new site was created.
- The panel registration will proceed.
- After a few minutes the Connection Status will change to "Network Connected" and the Registration Keys will be created. The registration keys are the Passcode that need to be given to the customer to allow monitoring and control of the site.

Wi-Fi IP Board

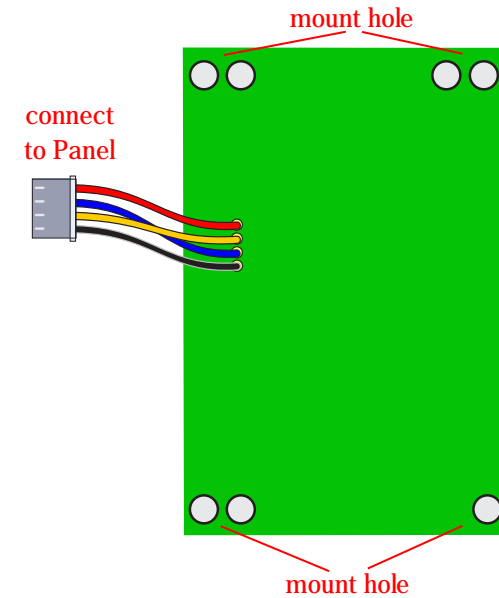

Mounting

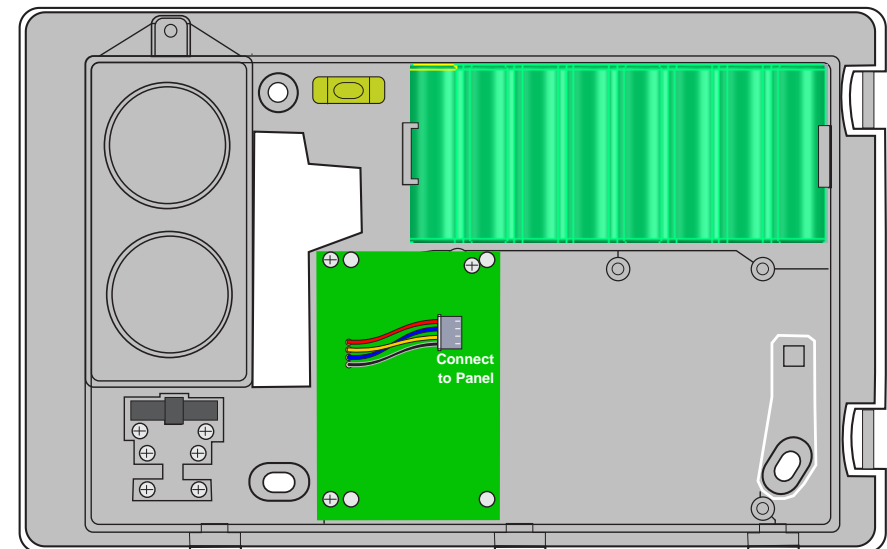

Getting Started with the GSD-i70 App

1. Install the GSDi-IP-2 Wi-Fi Plug on IP Communicator
 2. Register an Installer Account
 3. Download the GSD-i70 App
 4. Create a new site for the GSD-i70 Panel installation
 5. Register the GSD-i70 Panel
 6. Customer Registration
- (see detailed steps below)

1. Install the GSDi-IP-2 Wi-Fi IP board

Refer to the installation diagrams for mounting and wiring on page 3

2. Register an installer account

Each installer must call GSD to register an account for the GSD-i70 App. This only needs to be completed the one time.

The following details are required:

- Installer Name:
- Company:
- Address:
- Phone:
- Email: (This email address will be used by the GSD-i70 App to allow the installer to activate each new customer.)

GSD will provide an account number, username and password to use on the GSD-i70 App.

3. Download the GSD-i70 App

Download the GSD-i70 App from either iTunes  for IOS phones or Google Play  for Android Smart phones.

Supported versions:

IOS:

- Apple devices with iOS 6 and iOS 7

Android:

- Android devices with OS versions 2.3 - 4.4

4. Create a new site for the GSD-i70 panel

1. Login to the GSD-i70 App using the insatller username and password provided. The password should be changed on the Settings Screen.
2. On the Sites Screen, Enter a name for the new site and select "Add New Site". The site may be added to an existing customer in the drop down list, otherwise a form will be displayed to enter the new customer details.
3. After saving the new site details a unique Site ID is generated for this site.
4. The Site ID is then displayed in the list of sites on the Sites Screen.